

**ITEM 8.           ITEM FOR COMMITTEE INFORMATION – PARKING – BUS ZONE –  
                      SUSSEX STREET SYDNEY**

**TRIM RECORD NO:   2015/500104**

**RECOMMENDATION**

It is recommended that the Committee endorse the following reallocation of kerb space on the western side of Sussex Street, Sydney, south of Druitt Street:

- (A) Between the points 45.6 metres and 73.6 metres (five spaces) as “Bus Zone”;
- (B) Between the points 73.6 metres and 89.8 metres (three spaces) as “Loading Zone Ticket 6am-6pm, Mon-Fri; 6am-10am, Sat” and “4P Ticket 6pm-12am, Mon-Fri; 10am-10pm, Sat; 8am-10pm, Sun & Public Holidays”;
- (C) Between the points 89.8 metres and 96.8 metres (one space) as “Mail Zone”; and
- (D) The City, in conjunction with TfNSW, to review the provision of bus parking in Sussex Street, between Druitt and Bathurst Streets, six months after implementation.

**DECISION**

The Committee carried the recommendation unanimously out-of-session on 30 September 2015.

**BACKGROUND**

On 19 December 2013, the NSW Government adopted the Sydney City Centre Access Strategy (Access Strategy). The Access Strategy provides a clear direction for how all the different transport modes will work together in the Sydney CBD to reduce congestion, provide for future growth and improve the customer experience

The Sydney City Centre Bus Plan (SCCBP) forms part of a suite of transport improvements associated with the Access Strategy and includes:

- New dedicated Bus Lanes, Bus Stops and shelters;
- Modifying kerbs and footpaths, line markings and medians; and
- Removing and relocating some taxi ranks, Loading Zones and on-street parking spaces.

The SCCBP aims to:

- Provide a more efficient bus network that is easier for customers to use and understand;
- Create bus corridors within the CBD that improve links to key destinations and improve connectivity with other transport modes; and
- Relocate existing bus routes on George Street to enable delivery of the CBD Light Rail.

The SCCBP will be delivered by Roads and Maritime Services (RMS), in conjunction with Transport for New South Wales (TfNSW) and the City of Sydney.

**COMMENTS**

The kerb space on the western side of Sussex Street between Druitt and Bathurst Streets is currently signposted as “Loading Zone Ticket” and “2P/4P Ticket”. Two ticket spaces also include an exemption for CBD parking permits.

The proposed parking change seeks support to reallocate on-street parking to provide additional layover capacity for new bus services exiting the City via the Western Distributor.

Remaining on-street parking in this section of Sussex Street is proposed to be reallocated for loading capacity during weekday business hours and Saturday mornings and revert to “4P Ticket” at other times.

**CONSULTATION**

TfNSW notified affected stakeholders in the vicinity of the proposal. There were 1,013 letters sent out with no responses received on the proposal.

**FINANCIAL**

The Access Strategy is fully funded by the NSW Government.

**ATTACHMENTS**

Item for Committee Information – Parking – Bus Zone – Sussex Street Sydney

Lisa McGill, Senior CBD Precinct Planning Manager, Transport for NSW

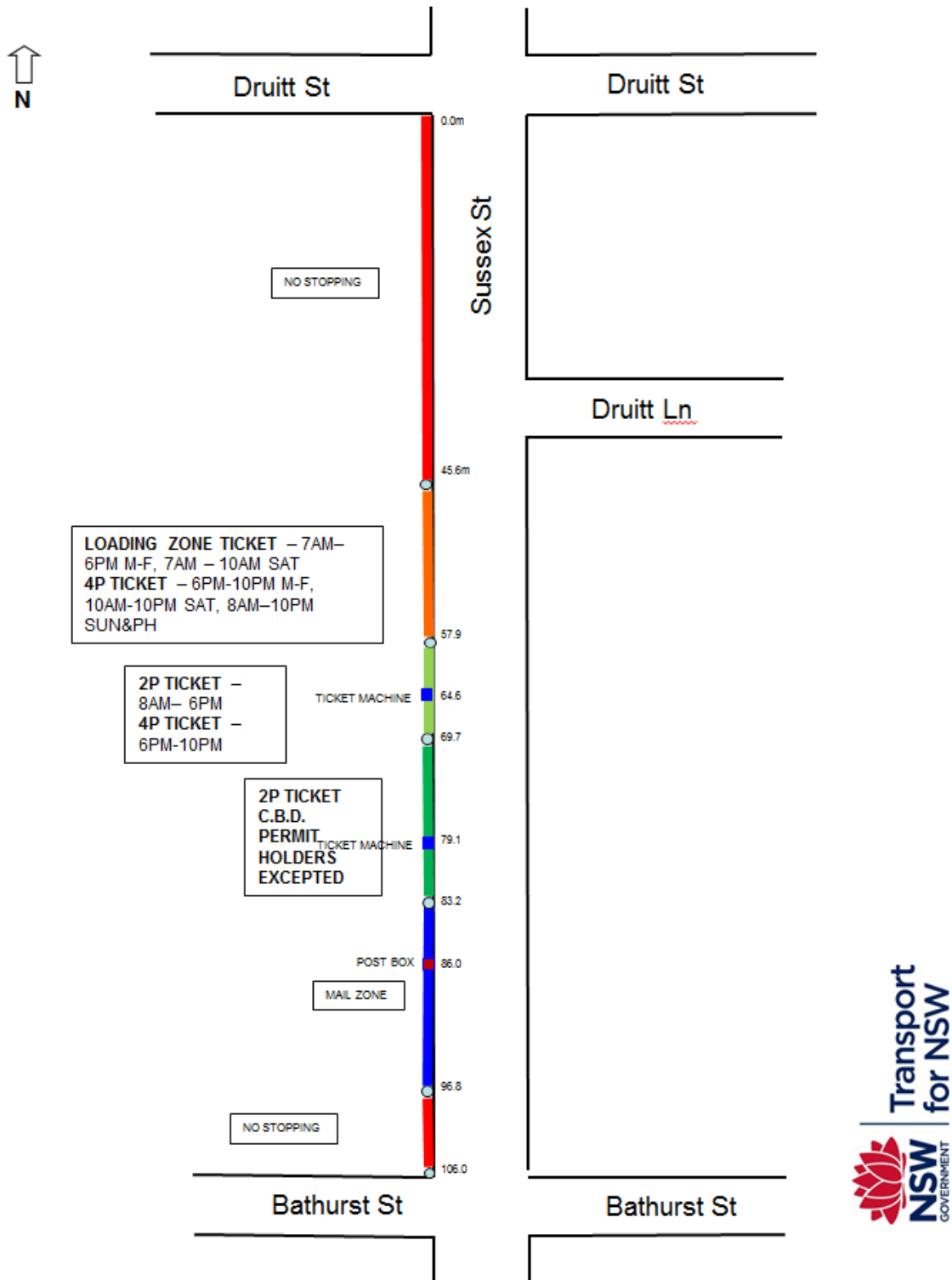

Existing signposting for western side of Sussex St btw Druitt and Bathurst St

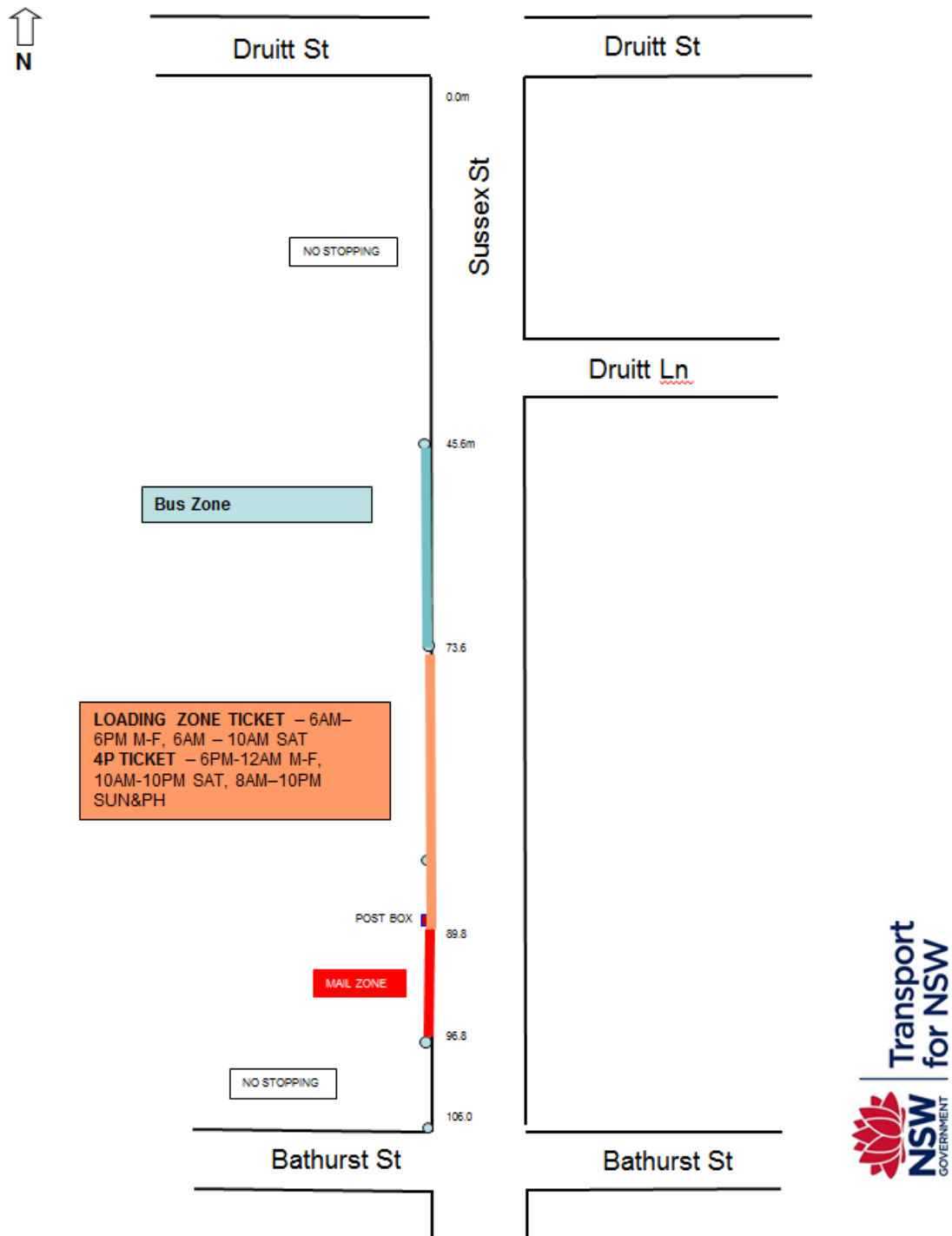

Proposed signposting for western side of Sussex St btw Druitt and Bathurst St